



High Road

Watford, WD25 7AP

Offers In Excess Of £275,000

HIGH ROAD HOPES! Perfect for a first time buyer or investment buyer, this two bedroom first floor maisonette provides ample living space featuring a spacious living area and separate Kitchen. With some modernisation needed, this is a perfect opportunity to create the home of your dreams! With its own private leafy garden and parking space!! Book viewings early to avoid disappointment!

- First Floor Maisonette
- Double and Single Bedroom
- Ideal For First Time Buyer Or Landlord
- Chain Free
- Bright and Airy
- Private Garden
- Walking Distance To Local Shops

Viewing

Please contact our Abbots Langley Office on 01923262666 if you wish to arrange a viewing appointment for this property or require further information.



2



1



null



C

Floor Plan

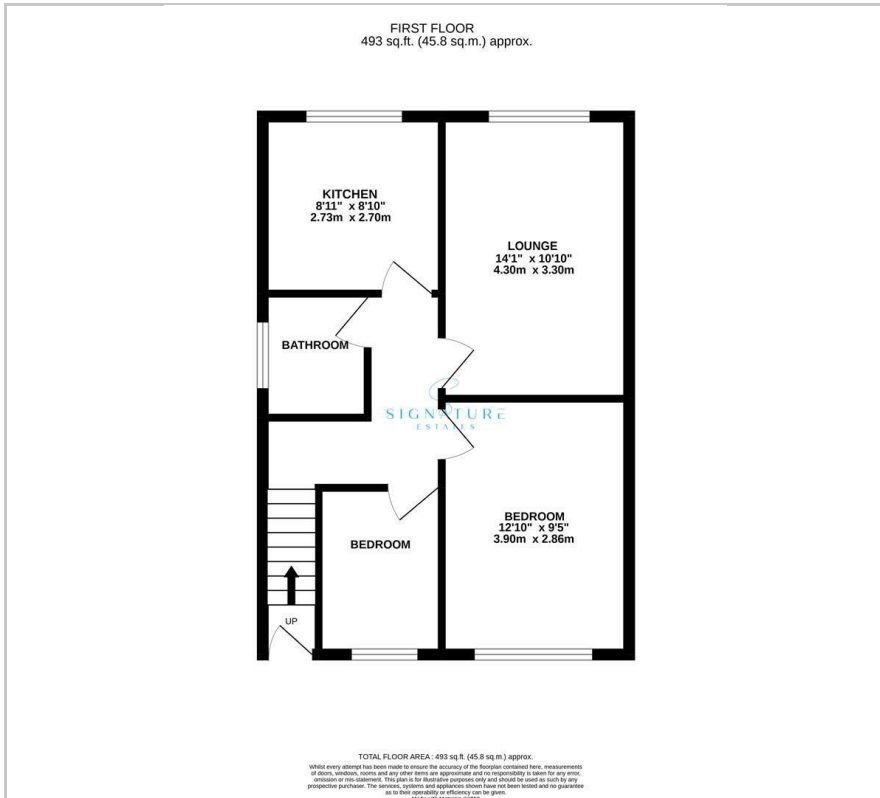

Area Map



Energy Efficiency Graph

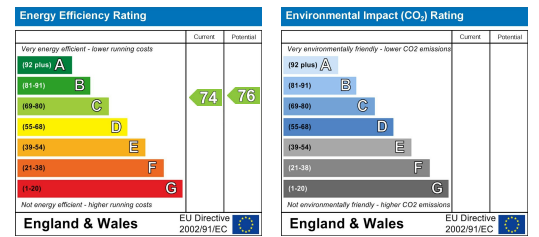

These particulars, whilst believed to be accurate are set out as a general outline only for guidance and do not constitute any part of an offer or contract. Intending purchasers should not rely on them as statements of representation of fact, but must satisfy themselves by inspection or otherwise as to their accuracy. No person in this firm's employment has the authority to make or give any representation or warranty in respect of the property.